



OFFICE FURNITURE & SEATING CATALOGUE
JANUARY 2022



COMMERCIAL FURNITURE PTY LTD



www.mrcommercialfurniture.com.au





COMMERCIAL FURNITURE PTY LTD

INDEX

Page 2 - 3	Vertilift 2-Leg Electric Height Adjustable Frame
Page 4 - 5	Vertilift 3-Leg Electric Height Adjustable Frame
Page 6 - 7	Vertilift Back-to-Back (2-Leg) Height Adjustable Frame
Page 8 - 9	Vertilift Back-to-Back (2-Leg/3-Leg) Height Adjustable Frame
Page 10 -11	Vertilift Back-to-Back (3-Leg) Height Adjustable Frame
Page 12	Vertilift Pro On-Desk Riser
Page 13	Vertilift Package Dimensions, Weights and Certifications
Page 14	Vertilift Fixed Height Frames, Telescopic Modesty, Monitor Arms
Page 15	Cable Management and Soft Wiring
Page 16 - 17	Pilot Beech over Ironstone Melamine Range
Page 18 - 19	Stella White Melamine Range
Page 20	Stella Melamine Top and Modesty Range
Page 21	KIS2 Steel Mobile Pedestals and Accessories
Page 22 - 32	Stateline Office Chairs (Task and Executive)
Page 33	Stateline Visitor Chairs and ED Visitor Chairs
Page 34	Stateline Office Chair Accessories
Page 35	Stateline AFRDI and BIFMA Certifications
Page 36	Spare Parts
Page 37	Warranty Information

Vertilift...

Excellence in motion

VERTILIFT 2-LEG DUAL MOTOR ELECTRIC HEIGHT ADJUSTABLE FRAME



- AFRDI Certified
- Height range 600mm - 1250mm
- Frame suits tops 600mm - 900mm deep
- Frame suits tops 1200mm - 1800mm long
- Optional extension beams will extend the frame to 2000mm long
- **Lift Capacity 130kg** evenly distributed
- Child Lock
- Anti Collision with soft start and stop
- Internal motors in each 3 stage column leg
- Thermal overheat protection
- 700mm long feet standard
- Optional 600mm long feet available
- Optional steel modesty (1100mm-1850mmL x 400mmH) mounts to underside of top (refer to Pg 14)
- 4 Position Memory handset
- 5 Year Warranty
- **Frame colour: Black, White, Silver**



CODE	DESCRIPTION
VN2*	Vertilift 2-Leg Frame
VertEXT*	Vertilift Extension Beams (pair) Optional
Vert600*	Vertilift 600W Feet - optional 600mm feet

* **Frame colour to be selected:** B = Black, W = White, S = Silver

VERTILIFT PACKAGE A

INCLUDES:

- 1 x Vertilift 2-Leg Frame
- 1 x Straight or Scallop top



STRAIGHT TOP

- **Top 1890** - 1800mmL x 900mmD x 25mmT
- **Top 1875** - 1800mmL x 750mmD x 25mmT
- **Top 1575** - 1500mmL x 750mmD x 25mmT
- No cable hole access - cable hole available for additional cost (includes 60mm cover)
- 25mm E1 particle board
- **Colour options: White**, (Beech colour discontinued and only available while stocks last)



SCALLOP TOP

- **T1** - 1800mmL x 750mmD x 25mmT
- **T2** - 1500mmL x 750mmD x 25mmT
- 600mm x 45mm scallop on back edge
- 25mm E1 particle board
- **Colour options: White**

CODE	DESCRIPTION
PACKAGE A.1	2-Leg Frame with 1800L x 900D Straight Top
PACKAGE A.2	2-Leg Frame with 1800L x 750D Straight or Scallop Top
PACKAGE A.3	2-Leg Frame 1500L x 750D Straight or Scallop Top

* **Frame colour to be selected:** B = Black, W = White, S = Silver

VERTILIFT PACKAGE B

INCLUDES:

- 1 x Vertilift 2-Leg Frame
- 1 x Straight or Scallop top
- 1 x Set of 90 degree legs
- 1 x Cable Tray



VERTILIFT 90 DEGREE LEGS

- 90 degree leg supports cable trays and partitions
- Side cable access for cables to run through frame into another
- **Colour options: Black, White, Silver**



VERTILIFT TELESCOPIC CABLE TRAY

- Cable tray with cut-outs for 8 x GPO and 8 x data
- Two sizes available; 1500mmL to 1800mmL or 1200mmL to 1500mmL
- Cannot use extension beams when Vertilift cable tray is fitted
- **Colour options: Black, White, Silver**

CODE	DESCRIPTION
V90*	90 degree support leg (pair)
VCT1215*	1200mmL - 1500mmL Telescopic Cable Tray
VCT1518*	1500mmL - 1800mmL Telescopic Cable Tray
PACKAGE B.1	2-Leg Frame + 1800L x 900D Straight top + 90 Degree legs + Cable tray
PACKAGE B.2	2-Leg Frame + 1800L x 750D Straight/Scallop top + 90 Degree legs + Cable tray
PACKAGE B.3	2-Leg Frame + 1500L x 750D Straight/Scallop top + 90 Degree legs + Cable tray

Vertilift...

Excellence in motion

VERTILIFT PACKAGE C

INCLUDES:

- 1 x Vertilift 2-Leg Frame
- 1 x Straight or Scallop top
- 1 x Set of 90 degree legs
- 1 x Cable Tray
- 1 x Set of Screen Brackets
- 1 x Screen

VERTILIFT SCREEN BRACKETS

- Sold separately to the screen
- Set includes 1 left and 1 right hand bracket
- **Colour options: Black, White, Silver**

VERTILIFT SCREENS

- Charcoal fabric with white frame
- Pinnable
- Overall screen height 1420mm from the ground
- 1500mmL x 1000mmH x 32mmT
- 1800mmL x 1000mmH x 32mmT



CODE	DESCRIPTION
VSB*	Screen bracket set
VertSC15W	1500mmL screen
VertSC18W	1800mmL screen
PACKAGE C.1	2-Leg Frame + 1800L x 900D Straight top + 90 Degree legs + Cable tray + Screen/Brackets
PACKAGE C.2	2-Leg Frame + 1800L x 750D Straight/Scallop top + 90 Degree legs + Cable tray + Screen/Brackets
PACKAGE C.3	2-Leg Frame + 1500L x 750D Straight/Scallop top + 90 Degree legs + Cable tray + Screen/Brackets

* **Frame colour to be selected:** B = Black, W = White, S = Silver

VERTILIFT PACKAGE D

INCLUDES:

- 1 x Vertilift 2-Leg Frame
- 1 x Straight or Scallop top
- 1 x Set of 90 degree legs
- 1 x Cable Tray
- 1 x Set of Screen Brackets
- 1 x Screen
- 1 x Cable Chain

VERTILIFT CABLE CHAIN

- 1200mm long cable chain
- Comes with fixing plates at each end and a weighted foot
- Cable chain will fit at both ends of the cable tray allowing two cable chains per work top if needed
- **Colour options: Black, White**



CODE	DESCRIPTION
ChainW / ChainB	Cable chain (Black or White)
PACKAGE D.1	2-Leg Frame + 1800L x 900D Straight top + 90 Degree legs + Cable tray + Screen/Brkts + Cable Chain
PACKAGE D.2	2-Leg Frame + 1800L x 750D Straight/Scallop top + 90 Degree legs + Cable tray + Screen/Brkts + C/Chain
PACKAGE D.3	2-Leg Frame + 1500L x 750D Straight/Scallop top + 90 Degree legs + Cable tray + Screen/Brkts + C/Chain

* **Frame colour to be selected:** B = Black, W = White, S = Silver

Vertilift...

Excellence in motion

VERTILIFT 3-LEG 3-MOTOR ELECTRIC HEIGHT ADJUSTABLE FRAME

- AFRDI Certified
- Height range 600mm - 1250mm
- Frame suits tops 600mm - 900mm deep
- Frame suits tops 1200mm - 1800mm long (front)
**Optional extension beams can be added to the front frame extending the frame to 2000mm long
- Return side extends from 1500mm - 2000mm long
- 3 leg **Lift Capacity 180kg** evenly distributed
- Child Lock
- Anti Collision with soft start and stop
- Internal motors in each 3-stage column
- Thermal overheat protection
- 700mm long feet standard
- Optional 600mm long feet available
- Optional steel modesty (1100mm-1850mmL x 400H) mounts to underside of top (refer to Pg 14)
- 4 Position Memory handset
- 5 Year Warranty
- **Frame colour: Black, White, Silver**



CODE	DESCRIPTION
VN3*	Vertilift 3 Leg Frame
VertEXT*	Vertilift Extension Beams (pair) **Optional
Vert600*	Vertilift 600W Feet - optional 600mm feet

* **Frame colour to be selected:** B = Black, W = White, S = Silver
 ** Optional extension beam can be added to front frame to extend to 2000mm

VERTILIFT PACKAGE E

INCLUDES:

- 1 x Vertilift 3-Leg Frame
- 1 x Corner top

CORNER TOP

- **T3** - 1800mmL x 1800mmW x 750mmD x 25mmT
- **T4** - 1800mmL x 1500mmW x 750mmD x 25mmT
- **T5** - 1800mmL x 1200mmW x 750mmD x 25mmT
- Cable hole access
- 25mm E1 particle board
- **Colour options: White**



CODE	DESCRIPTION
PACKAGE E.1	3-Leg Frame + 1800L x 1800W x 750D Corner Top
PACKAGE E.2	3-Leg Frame + 1800L x 1500W x 750D Corner Top
PACKAGE E.3	3-Leg Frame + 1800L x 1200W x 750D Corner Top

* **Frame colour to be selected:** B = Black, W = White, S = Silver

VERTILIFT PACKAGE F

INCLUDES:

- 1 x Vertilift 3-Leg Frame
- 1 x Corner top
- 1 x Set of 90 degree legs
- 1 x Cable tray

VERTILIFT 90 DEGREE LEGS

- 90 degree leg supports cable trays and partitions
- Side cable access for cables to run through frame into another
- **Colour: Black, White, Silver**

VERTILIFT TELESCOPIC CABLE TRAY

- Cable tray with cut-outs for 8 x GPO and 8 x data
- Two sizes available; 1500mmL to 1800mmL or 1200mmL to 1500mmL
- Cannot use extension beams when Vertilift cable tray is fitted
- **Colour: Black, White, Silver**



CODE	DESCRIPTION
V90*	90 Degree Support Leg (pair)
VCT1215*	1200mmL - 1500mmL Telescopic Cable Tray
VCT1518*	1500mmL - 1800mmL Telescopic Cable Tray
PACKAGE F.1	3-Leg Frame + 1800L x 1800W x 750D Corner Top + 90 Degree Legs + Cable Tray
PACKAGE F.2	3-Leg Frame + 1800L x 1500W x 750D Corner Top + 90 Degree Legs + Cable Tray
PACKAGE F.3	3-Leg Frame + 1800L x 1200W x 750D Corner Top + 90 Degree Legs + Cable Tray

Vertilift...

Excellence in motion

VERTILIFT PACKAGE G

INCLUDES:

- 1 x Vertilift 3-Leg Frame
- 1 x Corner top
- 1 x Set of 90 degree legs
- 1 x Cable Tray
- 1 x Set of Screen Brackets
- 1 x Screen

VERTILIFT SCREEN BRACKETS

- Sold separately to the screen
- Set includes 1 left and 1 right hand bracket
- **Colour options: Black, White, Silver**

VERTILIFT SCREEN

- Charcoal fabric with white frame
- Pinnable
- Overall screen height 1420mm from the ground
- 1500mmL x 1000mmH x 32mmT
- 1800mmL x 1000mmH x 32mmT



CODE	DESCRIPTION
VSB*	Screen Bracket Set
VertSC15W	1500 mmL Screen
VertSC18W	1800 mmL Screen
PACKAGE G.1	3-Leg Frame + 1800L x 1800W x 750D Top + 90 Degree Leg + Cable Tray + 1800L Screen/Brackets
PACKAGE G.2	3-Leg Frame + 1800L x 1500W x 750D Top + 90 Degree Leg + Cable Tray + 1800L Screen/Brackets
PACKAGE G.3	3-Leg Frame + 1500L x 1800W x 750D Top + 90 Degree Leg + Cable Tray + 1500L Screen/Brackets
PACKAGE G.4	3-Leg Frame + 1800L x 1200W x 750D Top + 90 Degree Leg + Cable Tray + 1800L Screen/Brackets

* **Frame colour to be selected:** B = Black, W = White, S = Silver

VERTILIFT PACKAGE H

INCLUDES:

- 1 x Vertilift 3-Leg Frame
- 1 x Corner top
- 1 x Set of 90 degree legs
- 1 x Cable Tray
- 1 x Set of Screen Brackets
- 1 x Screen
- 1 x Cable Chain

VERTILIFT CABLE CHAIN

- 1200mm long cable chain
- Comes with fixing plates at each end and a weighted foot
- Cable chain will fit at both ends of the cable tray allowing two cable chains per work top if needed
- **Colour options: Black, White**



CODE	DESCRIPTION
ChainW / ChainB	Cable Chain (Black or White)
PACKAGE H.1	3-Leg Frame + 1800L x 1800W x 750D Top + 90 Degree Leg + Cable Tray + 1800L Screen/Brkts + Cable Chain
PACKAGE H.2	3-Leg Frame + 1800L x 1500W x 750D Top + 90 Degree Leg + Cable Tray + 1800L Screen/Brkts + Cable Chain
PACKAGE H.3	3-Leg Frame + 1500L x 1800W x 750D Top + 90 Degree Leg + Cable Tray + 1500L Screen/Brkts + Cable Chain
PACKAGE H.4	3-Leg Frame + 1800L x 1200W x 750D Top + 90 Degree Leg + Cable Tray + 1800L Screen/Brkts + Cable Chain

* **Frame colour to be selected:** B = Black, W = White, S = Silver

Vertilift...

Excellence in motion

VERTILIFT PACKAGE I

BACK-TO-BACK 2-LEG ELECTRIC HEIGHT ADJUSTABLE FRAME

- AFRDI Certified

INCLUDES:

- 2 x Vertilift 2-Leg Frame
- 1 x Set of Cross Beams

VERTILIFT CROSS BEAM

- 725mm x 80mm x 50mm
- **Colour options: Black, White, Silver**



CODE	DESCRIPTION
VN2*	Vertilift 2-Leg Frame
VCB*	Vertilift Cross Beam Set
PACKAGE I 2 x 2-Leg Frame + Cross Beam Set	

* **Frame colour to be selected:** B = Black, W = White, S = Silver

VERTILIFT PACKAGE J

INCLUDES:

- 2 x Vertilift 2-Leg Frame
- 1 x Set of Cross Beams
- 2 x Straight or Scallop tops

STRAIGHT TOP

- **Top 1890** - 1800mmL x 900mmD x 25mmT
- **Top 1875** - 1800mmL x 750mmD x 25mmT
- **Top 1575** - 1500mmL x 750mmD x 25mmT
- No cable hole access - cable hole available for additional cost (includes 60mm cover)
- 25mm E1 particle board
- **Colour options: White**, (Beech colour discontinued and only available while stocks last)

SCALLOP TOP

- **T1** - 1800mmL x 750mmD x 25mmT
- **T2** - 1500mmL x 750mmD x 25mmT
- 600mm x 45mm scallop on back edge
- 25mm E1 particle board
- **Colour options: White**



CODE	DESCRIPTION
TOP1890	1800mmL x 900mmD x 25mmT Straight Top
TOP1875 / T1	1800mmL x 750mmD x 25mmT Straight or Scallop Top
TOP1575 / T2	1500mmL x 750mmD x 25mmT Straight or Scallop Top
PACKAGE J.1	2 x 2-Leg Frame + Cross Beams + 2 x 1800L x 900D Straight Tops
PACKAGE J.2	2 x 2-Leg Frame + Cross Beams + 2 x 1800L x 750D Straight/Scallop Tops
PACKAGE J.3	2 x 2-Leg Frame + Cross Beams + 2 x 1500L x 750D Straight/Scallop Tops

* **Frame colour to be selected:** B = Black, W = White, S = Silver

VERTILIFT PACKAGE K

INCLUDES:

- 2 x Vertilift 2-Leg Frame
- 1 x Set of Cross Beams
- 2 x Straight or Scallop tops
- 1 x Cable tray

VERTILIFT TELESCOPIC CABLE TRAY

- Cable tray with cut outs for 8 x GPO and 8 x data
- Two sizes available; 1500mmL to 1800mmL or 1200mmL to 1500mmL
- Cannot use extension beams when Vertilift cable tray is fitted
- **Colour options: Black, White, Silver**



CODE	DESCRIPTION
VCT1215*	1200mmL - 1500mmL Telescopic Cable Tray
VCT1518*	1500mmL - 1800mmL Telescopic Cable Tray
PACKAGE K.1	2 x 2-Leg Frame + Cross Beams + 2 x 1800L x 900D Straight Tops + Cable Tray
PACKAGE K.2	2 x 2-Leg Frame + Cross Beams + 2 x 1800L x 750D Straight/Scallop Tops + Cable Tray
PACKAGE K.3	2 x 2-Leg Frame + Cross Beams + 2 x 1500L x 750D Straight/Scallop Tops + Cable Tray

* **Frame colour to be selected:** B = Black, W = White, S = Silver

Vertilift...

Excellence in motion

VERTILIFT PACKAGE L

INCLUDES:

- 2 x Vertilift 2-Leg Frame
- 1 x Set of Cross Beams
- 2 x Straight or Scallop tops
- 1 x Cable Tray
- 2 x Set of Screen Brackets
- 1 x Screen

VERTILIFT SCREEN BRACKETS

- Sold separately to the screen
- Set includes 1 left and 1 right hand bracket
- **Colour options: Black, White, Silver**

VERTILIFT SCREEN

- Charcoal fabric with white frame
- Pinnable
- Overall screen height 1420mm from the ground
- 1500mmL x 1000mmH x 32mmT
- 1800mmL x 1000mmH x 32mmT



CODE	DESCRIPTION
VSB*	Screen Bracket Set x 2
VertSC15W	1500 mmL Screen
VertSC18W	1800 mmL Screen
PACKAGE L.1	2 x 2-Leg Frame + Cross Beams + 2 x 1800L x 900D Straight Tops + Cable Tray + Screen/Brackets
PACKAGE L.2	2 x 2-Leg Frame + Cross Beams + 2 x 1800L x 750D Straight/Scallop Tops + Cable Tray + Screen/Brkts
PACKAGE L.3	2 x 2-Leg Frame + Cross Beams + 2 x 1500L x 750D Straight/Scallop Tops + Cable Tray + Screen/Brkts

* Frame colour to be selected: B = Black, W = White, S = Silver

VERTILIFT PACKAGE M

INCLUDES:

- 2 x Vertilift 2-Leg Frame
- 1 x Set of Cross Beams
- 2 x Straight or Scallop tops
- 1 x Cable Tray
- 2 x Set of Screen Brackets
- 1 x Screen
- 2 x Cable Chains

VERTILIFT CABLE CHAIN

- 1200mm long cable chain
- Comes with fixing plates at each end and a weighted foot
- Cable chain will fit at both ends of the cable tray allowing two cable chains per work top if needed
- **Colour options: Black, White**



CODE	DESCRIPTION
ChainW / ChainB	Cable Chain (Black or White) x 2
PACKAGE M.1	2 x 2-Leg frame + Cross Beam + 2 x 1800L x 900D straight top + cable tray + screen/brkts + cable chain
PACKAGE M.2	2 x 2-Leg frame + Cross Beam + 2 x 1800L x 750D straight/scallop top + cable tray + screen/brkts + cable chain
PACKAGE M.3	2 x 2-Leg frame + Cross Beam + 2 x 1500L x 750D straight/scallop top + cable tray + screen/brkts + cable chain

* Colour to be selected: B = Black, W = White, S = Silver

Vertilift...

Excellence in motion

VERTILIFT PACKAGE N

BACK-TO-BACK (2-LEG + 3-LEG) ELECTRIC HEIGHT ADJUSTABLE FRAME

- AFRDI Certified

INCLUDES:

- 1 x Vertilift 2-Leg Frame
- 1 x Vertilift 3-Leg Frame
- 1 x Set of Cross Beams

VERTILIFT CROSS BEAM

- 725 mm x 80 mm x 50 mm
- **Colour options: Black, White, Silver**



CODE	DESCRIPTION
VN2*	Vertilift 2-Leg Frame
VN3*	Vertilift 3-Leg Frame
VCB*	Vertilift Cross Beam Set
PACKAGE N 2-Leg Frame + 3-Leg Frame + Cross Beam Set	

* Frame colour to be selected: B = Black, W = White, S = Silver

VERTILIFT PACKAGE O

INCLUDES:

- 1 x Vertilift 2-Leg Frame
- 1 x Vertilift 3-Leg Frame
- 1 x Set of Cross Beams
- 1 x Straight/Scalloped top
- 1 x Corner top

CORNER TOP (cable hole access)

- **T3** - 1800mmL x 1800mmW x 750mmD x 25mmT
- **T4** - 1800mmL x 1500mmW x 750mmD x 25mmT
- **T5** - 1800mmL x 1200mmW x 750mmD x 25mmT
- **Colour options: White**

STRAIGHT TOP (no cable hole access)

- **Top 1890** - 1800mmL x 900mmD x 25mmT
- **Top 1875** - 1800mmL x 750mmD x 25mmT
- **Top 1575** - 1500mmL x 750mmD x 25mmT
- **Colour options: White, Beech** (colour discontinued - available while stocks last)

SCALLOP TOP (White only)

- **T1** - 1800mmL x 750mmD x 25mmT
- **T2** - 1500mmL x 750mmD x 25mmT
- 600mm x 45mm scallop on back edge



CODE	DESCRIPTION
Package O 2-Leg Frame + 3-Leg Frame + Cross Beam Set (excluding tops)	
Select one straight and one corner top and add prices to the above package price	
TOP CODES	TOP CODES
Top 1890 1800mmL x 900mmD x 25mmT	T2 (Scalloped) 1500mmL x 750mmD x 25mmT
Top 1875 1800mmL x 750mmD x 25mmT	T3 1800mmL x 1800mmW x 750mmD x 25mmT
Top 1575 1500mmL x 750mmD x 25mmT	T4 1800mmL x 1500mmW x 750mmD x 25mmT
T1 (Scalloped) 1800mmL x 750mmD x 25mmT	T5 1800mmL x 1200mmW x 750mmD x 25mmT

* Frame colour to be selected: B = Black, W = White, S = Silver

VERTILIFT PACKAGE P

INCLUDES:

- 1 x Vertilift 2-Leg Frame
- 1 x Vertilift 3-Leg Frame
- 1 x Set of Cross Beams
- 1 x Straight/Scalloped top
- 1 x Corner top
- 1 x Cable Tray

VERTILIFT TELESCOPIC CABLE TRAY

- Cable tray with cut outs for 8 x GPO and 8 x data
- Two sizes available; 1500mmL to 1800mmL or 1200mmL to 1500mmL
- Cannot use extension beams when Vertilift cable tray is fitted
- **Colour options: Black, White, Silver**



CODE	DESCRIPTION
VCT1215* OR VCT1518*	1200mmL - 1500mmL / 1500mmL - 1800mmL Telescopic Cable Tray
Package P 2-Leg Frame + 3-Leg Frame + Cross Beam Set + Cable Tray (excluding tops)	
Select one straight and one corner top and add prices to the above package price	
TOP CODES	TOP CODES
Top 1890 1800mmL x 900mmD x 25mmT	T2 (Scalloped) 1500mmL x 750mmD x 25mmT
Top 1875 1800mmL x 750mmD x 25mmT	T3 1800mmL x 1800mmW x 750mmD x 25mmT
Top 1575 1500mmL x 750mmD x 25mmT	T4 1800mmL x 1500mmW x 750mmD x 25mmT
T1 (Scalloped) 1800mmL x 750mmD x 25mmT	T5 1800mmL x 1200mmW x 750mmD x 25mmT

* Frame colour to be selected: B = Black, W = White, S = Silver

Vertilift...

Excellence in motion

VERTILIFT PACKAGE Q

INCLUDES:

- 1 x Vertilift 2-Leg Frame
- 1 x Vertilift 3-Leg Frame
- 1 x Set of Cross Beams
- 1 x Straight/Scalloped top
- 1 x Corner top
- 1 x Cable Tray
- 2 x Set of Screen Brackets
- 1 x Screen

VERTILIFT SCREEN BRACKETS

- Sold separately to the screen
- Set includes 1 left and 1 right hand bracket
- **Colour options: Black, White, Silver**

VERTILIFT SCREEN

- Charcoal fabric with white frame
- Pinnable
- Overall screen height 1420mm from the ground
- 1500mmL x 1000mmH x 32mmT
- 1800mmL x 1000mmH x 32mmT



CODE	DESCRIPTION
VSB	Screen Bracket Set x 2
VertSC15W	1500mmL Screen
VertSC18W	1800mmL Screen
Package Q.1 2-Leg Frame + 3-Leg Frame + Cross Beam Set + Cable Tray + 1500L Screen/Brkts (excluding tops)	
Package Q.2 2-Leg Frame + 3-Leg Frame + Cross Beam Set + Cable Tray + 1800L Screen/Brkts (excluding tops)	

Select one straight and one corner top and add prices to the above package price

TOP CODES	TOP CODES
Top 1890 1800mmL x 900mmD x 25mmT	T2 (Scalloped) 1500mmL x 750mmD x 25mmT
Top 1875 1800mmL x 750mmD x 25mmT	T3 1800mmL x 1800mmW x 750mmD x 25mmT
Top 1575 1500mmL x 750mmD x 25mmT	T4 1800mmL x 1500mmW x 750mmD x 25mmT
T1 (Scalloped) 1800mmL x 750mmD x 25mmT	T5 1800mmL x 1200mmW x 750mmD x 25mmT

* **Frame colour to be selected:** B = Black, W = White, S = Silver

VERTILIFT PACKAGE R

INCLUDES:

- 1 x Vertilift 2-Leg Frame
- 1 x Vertilift 3-Leg Frame
- 1 x Set of Cross Beams
- 1 x Straight/Scalloped top
- 1 x Corner top
- 1 x Cable Tray
- 2 x Set of Screen Brackets
- 1 x Screen
- 2 x Cable chain

VERTILIFT CABLE CHAIN

- 1200mm long cable chain
- Comes with fixing plates at each end and a weighted foot
- Cable chain will fit at both ends of the cable tray allowing two cable chains per work top if needed
- **Colour options: Black, White**



CODE	DESCRIPTION
CHAINW / CHAINB	Cable Chain (Black or White) x 2
PACKAGE R.1 2-Leg Frame + 3-Leg Frame + Cross Beams + Cable Tray + 1500L Screen/Brkts + Cable Chain (excl tops)	
PACKAGE R.2 2-Leg Frame + 3-Leg Frame + Cross Beams + Cable Tray + 1800L Screen/Brkts + Cable Chain (excl tops)	

Select one straight and one corner top and add prices to the above package price

TOP CODES	TOP CODES
Top 1890 1800mmL x 900mmD x 25mmT	T2 (Scalloped) 1500mmL x 750mmD x 25mmT
Top 1875 1800mmL x 750mmD x 25mmT	T3 1800mmL x 1800mmW x 750mmD x 25mmT
Top 1575 1500mmL x 750mmD x 25mmT	T4 1800mmL x 1500mmW x 750mmD x 25mmT
T1 (Scalloped) 1800mmL x 750mmD x 25mmT	T5 1800mmL x 1200mmW x 750mmD x 25mmT

* **Frame colour to be selected:** B = Black, W = White, S = Silver

Vertilift...

Excellence in motion

VERTILIFT PACKAGE S

BACK-TO-BACK 3-LEG ELECTRIC HEIGHT ADJUSTABLE FRAME

- AFRDI Certified

INCLUDES:

- 2 x Vertilift 3-Leg Frames
- 1 x Set of Cross Beams

VERTILIFT CROSS BEAM

- 725 mmL x 80 mmH x 50 mmW
- **Colour options: Black, White, Silver**



CODE	DESCRIPTION
VN3*	Vertilift 3-Leg Frame x 2
VCB*	Vertilift Cross Beam Set
PACKAGE S 2 x 3-Leg Frames + Cross Beam Set	

* **Frame colour to be selected:** B = Black, W = White, S = Silver

VERTILIFT PACKAGE T

INCLUDES:

- 2 x Vertilift 3-Leg Frames
- 1 x Set of Cross Beams
- 2 x Corner tops

CORNER TOP (cable hole access)

- **T3** - 1800mmL x 1800mmW x 750mmD x 25mmT
- **T4** - 1800mmL x 1500mmW x 750mmD x 25mmT
- **T5** - 1800mmL x 1200mmW x 750mmD x 25mmT
- **Colour options: White**



CODE	DESCRIPTION
PACKAGE T 2 x 3-Leg Frames + Cross Beam Set (excluding tops)	
Select two corner tops and add prices to the above package price	
TOP CODES	
T3	1800mmL x 1800mmW x 750mmD x 25mmT
T4	1800mmL x 1500mmW x 750mmD x 25mmT
T5	1800mmL x 1200mmW x 750mmD x 25mmT

* **Frame colour to be selected:** B = Black, W = White, S = Silver

VERTILIFT PACKAGE U

INCLUDES:

- 2 x Vertilift 3-Leg Frames
- 1 x Set of Cross Beams
- 2 x Corner tops
- 1 x Cable Tray

VERTILIFT TELESCOPIC CABLE TRAY

- Cable tray with cut outs for 8 x GPO and 8 x data
- Two sizes available; 1500mmL to 1800mmL or 1200mmL to 1500mmL
- Cannot use extension beams when Vertilift cable tray is fitted
- **Colour options: Black, White, Silver**



CODE	DESCRIPTION
VCT1215* OR VCT1518*	1200mmL - 1500mmL / 1500mmL - 1800mmL Telescopic Cable Tray
Package U 2 x 3-Leg Frames + Cross Beam Set + Cable Tray (excluding tops)	
Select two corner tops and add prices to the above package price	
TOP CODES	
T3	1800mmL x 1800mmW x 750mmD x 25mmT
T4	1800mmL x 1500mmW x 750mmD x 25mmT
T5	1800mmL x 1200mmW x 750mmD x 25mmT

Vertilift...

Excellence in motion

VERTILIFT PACKAGE V

INCLUDES:

- 2 x Vertilift 3-Leg Frames
- 1 x Set of Cross Beams
- 2 x Corner tops
- 1 x Cable Tray
- 2 x Set of Screen Brackets
- 1 x Screen

VERTILIFT SCREEN BRACKETS

- Sold separately to the screen
- Set includes 1 left and 1 right hand bracket
- **Colour options: White, Black, Silver**

VERTILIFT SCREEN

- Charcoal fabric with white frame
- Overall screen height 1420mm from the ground
- 1500mmL x 1000mmH x 32mmT
- 1800mmL x 1000mmH x 32mmT



CODE	DESCRIPTION
VSB	Screen Bracket Set x 2
VertSC15W	1500mmL Screen
VertSC18W	1800mmL Screen
PACKAGE V.1	2 x 3-Leg Frames + Cross Beam Set + Cable Tray + 1500L Screen/Brackets (excluding tops)
PACKAGE V.2	2 x 3-Leg Frames + Cross Beam Set + Cable Tray + 1800L Screen/Brackets (excluding tops)

Select two corner tops and add prices to the above package price

TOP CODES
T3 1800mmL x 1800mmW x 750mmD x 25mmT
T4 1800mmL x 1500mmW x 750mmD x 25mmT
T5 1800mmL x 1200mmW x 750mmD x 25mmT

* **Frame colour to be selected:** B = Black, W = White, S = Silver

VERTILIFT PACKAGE W

INCLUDES:

- 2 x Vertilift 3-Leg Frames
- 1 x Set of Cross Beams
- 2 x Corner tops
- 1 x Cable Tray
- 2 x Set of Screen Brackets
- 1 x Screen
- 2 x Cable chains

VERTILIFT CABLE CHAIN

- 1200mm long cable chain
- Comes with fixing plates at each end and a weighted foot
- Cable chain will fit at both ends of the cable tray allowing two cable chains per work top if needed
- **Colour options: Black, White**



CODE	DESCRIPTION
CHAINW / CHAINB	Cable Chain (Black or White) x 2
PACKAGE W.1	2 x 3-Leg Frames + Cross Beam Set + Cable Tray + 1500L Screen/Brackets + Cable Chain (excl tops)
PACKAGE W.2	2 x 3-Leg Frames + Cross Beam Set + Cable Tray + 1800L Screen/Brackets + Cable Chain (excl tops)

Select two corner tops and add prices to the above package prices:

TOP CODES
T3 1800mmL x 1800mmW x 750mmD x 25mmT
T4 1800mmL x 1500mmW x 750mmD x 25mmT
T5 1800mmL x 1200mmW x 750mmD x 25mmT

* **Frame colour to be selected:** B = Black, W = White, S = Silver

Vertilift...

Excellence in motion

VERTILIFT PRO

- Electric On-Desk Riser
- Monitor Platform 880W x 465D
- Monitor Platform height range 145 -510mm
- Monitor Platform weight rating 32kg
- Keyboard Platform 840W x 255D
- Keyboard Platform weight rating 3kg
- USB charging on control panel
- 5 Year Warranty
- Keyboard requires attachment (hand fit 4 screws)
- Speed: 29mm/second
- **Colour options: Black, White**



CODE	DESCRIPTION	CARTON DIMENSIONS	CRTN QTY	WEIGHT / VOL
VertiPro*	Vertilift Pro On-Desk Riser	950mm x 223mm x 567mm	1	21KG (0.13CBM)

* Colour to be selected: B = Black, W = White

VERTILIFT PRO PACKAGE 1

INCLUDES:

- 1 x Vertilift Pro On-Desk Riser
- 1 x Single Monitor Arm
- **Colour options: Black, White**

VERTILIFT PRO PACKAGE 2

INCLUDES:

- 1 x Vertilift Pro On-Desk Riser
- 1 x Dual Monitor Arm
- **Colour options: Black, White**

MONITOR ARM

- Weight Capacity 1.5kg - 7kg per arm
- Monitor size 13-27inch
- Gas lift with weight adjustment to suit specific monitor weight
- Installation options; clamp or through-top installation
- 5 Year Warranty
- **Colour: Black or White with Black Trim**



PICTURE OF VERTIPRO SHOWN WITH DUAL MONITOR ARM

CODE	DESCRIPTION	CARTON DIMENSIONS	CRTN QTY	WEIGHT / VOL
VertiPro*	Vertilift Pro On-Desk Riser	950mm x 223mm x 567mm	1	21KG (0.13CBM)
MONS*	Single Monitor Arm	420mm x 335mm x 110mm	1	4KG (0.02CBM)
MOND*	Dual Monitor Arm	415mm x 330mm x 155mm	1	5KG (0.02CBM)

PACKAGE 1 1 X Vertilift Pro On-Desk Riser + Single Monitor Arm

PACKAGE 2 1 X Vertilift Pro On-Desk Riser + Dual Monitor Arm

* Colour to be selected: B = Black, W = White

Vertilift...

Excellence in motion

VERTILIFT COMPONENTS - CARTON DIMENSIONS AND WEIGHTS

CODE	DESCRIPTION	CARTON DIMENSIONS	CARTON QTY	WEIGHT	VOLUME
VN2	Vertilift 2 Leg Electric Frame	1080mm x 248mm x 230mm	1	28.5kg	0.062CBM
VN3	Vertilift 3 Leg Electric Frame	1060mm x 400mm x 225mm	1	47kg	0.095CBM
V90	90 Degree Support Leg (pair)	460mm x 435mm x 125mm	1	6.5kg	0.025CBM
VCT1215	Cable Tray 1200mm - 1500mm	985mm x 110mm x 160mm	1	7kg	0.017CBM
VCT1518	Cable Tray 1500mm - 1800mm	1325mm x 110mm x 160mm	1	8.5kg	0.023CBM
VS	Vertilift Screen Brackets (pair)	160mm x 160mm x 60mm	1	500g	0.002CBM
VertSC15W	Vertilift 1500mmL Screen	1545mm x 1060mm x 45mm	1	10kg	0.074CBM
VertSC18W	Vertilift 1800mmL Screen	1845mm x 1060mm x 45mm	1	12kg	0.088CBM
VCB	Vertilift Cross Beams (pair)	740mm x 120mm x 100mm	1	7kg	0.009CBM
ChainW / ChainB	Vertilift Cable Chain	455mm x 120mm x 85mm	1	700g	0.005CBM
Vert600	Vertilift Electric 600mm foot	600mm x 70mm x 35mm (20mm without adjustable feet)	1	1.65kg	0.001CBM
VertEXT	Vertilift Extension Beams (pair)	1200mm x 30mm x 30mm	1	2.3kg	0.001CBM
VertiPro	Vertilift Pro On-Desk Riser	950mm x 223mm x 567mm	1	21kg	0.12BM

VERTILIFT AFRDI CERTIFICATION



The following components are AFRDI certified:

- 2-Leg Frame
- 3-Leg Frame
- Back-to-Back Frame

Under the Blue Tick Product Certification these components are certified for:

- General Safety
- Strength and Durability
- Stability
- Dimensions

Certificate No.

14255/1

Nominal Expiry

15 March 2024

The following Vertilift package components are not AFRDI certified:

- Straight/Corner tops
- Cable Tray
- Screen / Screen Brackets
- Cable Chain
- 90 Degree Leg
- Any other accessories pictured in package images

VERTILIFT ELECTRICAL COMPONENT CERTIFICATION



The electrical components included in 2-Leg, 3-Leg and Back-to-Back Vertilift Frames are certified by 'Global-Mark' in accordance with the Global-Mark Electrical Product Safety Certification Scheme.

Certificate No.

GMA-507385

Expiry date

01 June 2025

This certification is in accordance with the following standard:

"AS/NZS 60335.1:2011 including A1 - 4 Household and similar electrical appliances - Safety - General requirements"

Vertilift...

Excellence in motion

VERTILIFT 2 LEG FIXED HEIGHT FRAME V2.0

- Height 695mm (720mm with top)
- Frame suits tops 600mm to 800mm deep
- Frame suits tops 1200mm to 1850mm wide
- Optional Extension Beams will extend the frame to 2000mm wide
- Optional Modesty Panel extends from 1100mm to 1850mm wide
- **Modesty cannot be used when desk exceeds more than 1850mmL.**
- Foot length is 620mm, includes levelling feet
- 10 Year warranty
- **Frame Colour: Black, White**



CODE	DESCRIPTION	CARTON DIMENSIONS	CRTN QTY	WEIGHT / VOL
V1Stat2*	2 Leg Fixed Height Frame	1050mm x 200mm x 210mm	1	17.5KG (0.05CBM)
VertEXT*	Optional Extension Beams	1200 mm x 30 mm x 30 mm	1 PAIR	2.3KG (0.001CBM)

* Frame colour to be selected: B = Black, W = White

VERTILIFT 3 LEG FIXED HEIGHT FRAME V2.0

- Height 695mm (720mm with top)
- Frame suits tops 600mm to 800mm deep
- Frame suits tops 1200mm to 1850mm (front)
- ** Optional extension beams can be added to front frame, extending the frame to 2000mm long
- Return side extends from 1500mm to 2000mm long
- Optional Modesty Panel extends from 1100mm to 1850mm wide and can be used on both the front and return using the Vertilift Modesty Brackets
- Modesty cannot be used when desk exceeds more than 1850mmL
- Foot length is 620mm, includes levelling feet
- 10 Year warranty
- **Frame Colour: Black, White**



CODE	DESCRIPTION	CARTON DIMENSIONS	CRTN QTY	WEIGHT / VOL
V1Stat3*	3 Leg Fixed Height Frame	1120 mm x 320 mm x 215 mm	1	25.5KG (0.095CBM)
VertEXT*	Optional Extension Beams	1200 mm x 30 mm x 30 mm	1 PAIR	2.3KG (0.001CBM)

* Frame colour to be selected: B = Black, W = White

VERTILIFT MODESTY PANEL

- Modesty extends from 1100mmL to 1850mmL x 400mmH (290mm from base to floor)
- Modesty cannot be used when extension beams are fitted (when static frames are longer than 1850mm)
- Mounts to the underside of top using the Vertilift Modesty Brackets (VMB)
- Can be used with Vertilift Electric Frame and Vertilift Static Frame
- **Colour: Black, White**



CODE	DESCRIPTION	CARTON DIMENSIONS	CRTN QTY	WEIGHT / VOL
VMod*	Vertilift Modesty Panel	1010 mm x 430 mm x 40 mm	1	6.6KG (0.17CBM)
VMB*	Vertilift Modesty Bracket	240 mm x 120 mm x 60 mm	1	0.5KG (0.002CBM)

* Colour to be selected: B = Black, W = White

VERTILIFT MONITOR ARMS

- Weight Capacity 1.5kg - 7kg per arm
- Monitor size 13-27inch
- Gas lift with weight adjustment to suit specific monitor weight
- Clamp or through-top installation
- 5 year warranty
- **Colour: White with Black Trim or Black All Over**



CODE	DESCRIPTION	CARTON DIMENSIONS	CRTN QTY	WEIGHT / VOL
MONS*	Single Monitor Arm	415mm x 330mm x 110mm	1	4KG (0.02CBM)
BOX OF 2	Box of 2 Single Arms	430mm x 225mm x 345mm	2	6.5KG (0.04CBM)
MOND*	Dual Monitor Arms	420mm x 330mm x 155mm	1	5KG (0.02CBM)
BOX OF 2	Box of 2 Dual Arms	430mm x 330mm x 355mm	2	9.5KG (0.04CBM)

SOFT WIRING ACCESSORIES

GPO OUTLET

Dual Available in White or Black

Quad Available in White or Black

- Clips in to Vertilift Cable Tray, does not require GPO clip
- Clips in to Wire Cable Tray, requires GPO clip



CODE
DUAL - VL1802
QUAD - VL1804

GPO CLIP

Available in White only

- Required when attaching GPO Outlet to Wire Cable Tray



CODE
VLWGCBWT

CLIP IN DATA/VOICE BEZEL

Available in White only

- Clips in to Vertilift Cable Tray data panel

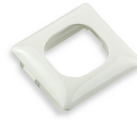

CODE
VLBEZGWT

45 DEGREE DATA TILE

Available in White only

- Clips into wire cable tray



CODE
VLWGC45DWT

SINGLE SIDE ENTRY 20AMP STARTER SOCKET

Available in White or Black



CODE
VL84011

3 METRE STARTER CABLE WITH 10 AMP PLUG

Available in White or Black

- Thermal overload 300mm from plug



CODE
VLT5A30

LINK CABLES

Available in White or Black

Standard size:

500mm, 1000mm, 1500mm, 2000mm

Non-standard sizes: (POA)

2500mm, 3000mm, 3500mm, 4000mm, 4500mm, 5000mm, 6000mm, 7000mm, 8000mm, 9000mm, 10000mm



NAME / CODE
500mm link / VL5205
1000mm link / VL5210
1500mm link / VL5215
2000mm link / VL5220

CABLE TRAYS

Single Tier Available in White or Black

Dual Tier Available in White or Black

- 50mm x 50mm Wire Tray
- Supplied with with 2 x Mounting Brackets

Standard lengths:

650mm, 950mm, 1250mm, 1550mm, 1750mm, 2050mm

Brackets can be purchased separately:

Bracket for Single Tier, set of 2- CTBS

Bracket for Dual Tier, set of 2- CTBD

CABLE TRAY IMAGES SHOWN WITH OPTIONAL GPO AND GPO CLIP

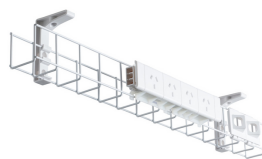

SINGLE TIER

CODE	DIMENSIONS
CT65S	650mm x 50mm x 50mm
CT95S	950mm x 50mm x 50mm
CT12S	1250mm x 50mm x 50mm
CT15S	1550mm x 50mm x 50mm
CT17S	1750mm x 50mm x 50mm
CT20S	2050mm x 50mm x 50mm
CTBS	105mm x 65mm x 20mm

DUAL TIER

CODE	DIMENSIONS
CT65D	650mm x 50mm x 50mm
CT95D	950mm x 50mm x 50mm
CT12D	1250mm x 50mm x 50mm
CT15D	1550mm x 50mm x 50mm
CT17D	1750mm x 50mm x 50mm
CT20D	2050mm x 50mm x 50mm
CTBD	205mm x 65mm x 20mm



STELLA

PILOT MELAMINE RANGE BEECH OVER IRONSTONE

DESK

With cable access and adjustable feet
25 mm over 25 mm

- P1** 1800mmW x 900mmD x 720mmH
- P36** 1800mmW x 750mmD x 720mmH
- P2** 1500mmW x 750mmD x 720mmH
- P3** 1200mmW x 750mmD x 720mmH
- P4** 1200mmW x 600mmD x 720mmH
No cable access for P4

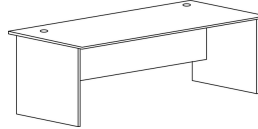

CODE	CARTON DIMENSIONS	CRTN QTY	WEIGHT / VOL
P1	1840mm x 940mm x 26mm	2	62KG (0.16CBM)
	1770mm x 728mm x 45mm		
P36	1840mm x 790mm x 27mm	2	53KG (0.15CBM)
	1742mm x 728mm x 45mm		
P2	1540mm x 790mm x 26mm	2	47KG (0.12CBM)
	1472mm X 728mm x 45mm		
P3	1416mm x 790mm x 70mm	1	40KG (0.1CBM)
P4	1416mm x 640mm x 70mm	1	34KG (0.08CBM)

RETURN

Left or Right hand, Reversible
25 mm over 25 mm

- P5** 1200mmW x 600mmD x 720mmH
- P6** 900mmW x 600mmD x 720mmH
- P80** 600mmW x 600mmD x 720mmH

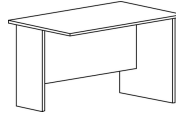

CODE	CARTON DIMENSIONS	CRTN QTY	WEIGHT / VOL
P5	1240mm x 728mm x 70mm	1	30KG (0.08CBM)
P6	940mm x 728mm x 70mm	1	27KG (0.06CBM)
P80	640mm x 728mm x 95mm	1	27KG (0.05CBM)

BRIDGING LEG

Use to extend L-Shape or Corner Workstations
25mmT

- P38** 260mmW x 695mmH x 25mmT



CODE	CARTON DIMENSIONS	CRTN QTY	WEIGHT / VOL
P38	750mm x 300mm x 26mm	1	4KG (0.01CBM)

PILOT WORKSTATION

Available Left or Right hand - With Cable Access
25 mm over 25 mm

Main desk 750 deep with 600 deep returns

- P54** 1800mmL x 1200mmW x 720mmH
- P54** With P55 Return - 1800mmL x 1500mmW
- P54** With P56 Return - 1800mmL x 1800mmW

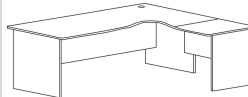

CODE	CARTON DIMENSIONS	CRTN QTY	WEIGHT / VOL
P54	1840mm x 1240mm x 45mm	2	75.5KG (0.22CBM)
	1390mm x 728mm x 52mm		
P54+P55	690mm x 490mm x 45mm	1	7.2KG (0.03CBM)
P54+P56	905mm x 640mm x 45mm	1	12.2KG (0.04CBM)

L - SHAPE DESK

Available Left or Right hand - With Cable Access
25 mm over 25 mm

- P11** 1500mmL x 1200mmW x 600mmD x 720mmH

- 11L** = 1200mmL on the **LEFT** as you sit at the desk
- 11R** = 1200mmL on the **RIGHT** as you sit at the desk

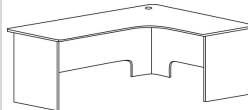

CODE	CARTON DIMENSIONS	CRTN QTY	WEIGHT / VOL
P11L	1540mm x 1240mm x 26mm	2	69KG (0.13CBM)
	1415mm x 728mm x 63mm		
P11R	1540mm x 1240mm x 26mm	2	69KG (0.13CBM)
	1415 mm x 728 mm x 63 mm		

May be extended either left or right by adding return code: 5, 6 or 80 plus bridging leg code : 38

CORNER UNIT

With Cable Access and Adjustable Feet
25 mm over 25 mm

- P12** 900mmW x 900mmD x 720mmH

- Add returns:
- P5 - 1200mmW x 600mmD
 - P6 - 900mmW x 600mmD
 - P80 - 600mmW X 600mmD

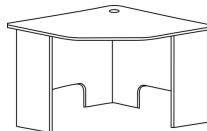

CODE	CARTON DIMENSIONS	CRTN QTY	WEIGHT / VOL
P12	988mm x 940mm x 77mm	1	36KG (0.09CBM)

MOBILE PEDESTAL

2 Drawers + 1 File Drawer - with Lock and Pencil Tray

- P14** 415mmW x 500mmD x 675mmH



CODE	CARTON DIMENSIONS	CRTN QTY	WEIGHT / VOL
P14	420mm x 505mm x 663mm	1	27KG (0.15CBM)

Factory assembled - castors and handles to be fitted



STELLA

PILOT MELAMINE RANGE BEECH OVER IRONSTONE

BOOKCASE

25mm Top, Base and Shelves, 18mm Sides and Back
308mm D Shelves

- P19** 900mmW x 330mmD x 1800mmH
(1 Fixed, 3 Adjustable Shelves) *image displayed
P42 900mmW x 330mmD x 900mmH
(2 Adjustable Shelves) *image not displayed

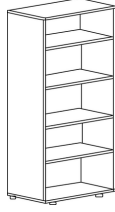

CODE	CARTON DIMENSIONS	CRTN QTY	WEIGHT / VOL
P19	940mm x 374mm x 153mm	2	66KG (0.15CBM)
	1765mm x 898mm x 37mm		
P42	898mm x 868mm x 38mm	2	38KG (0.09CBM)
	960mm x 374mm x 102mm		

STATIONERY CABINET

25mm Top, Base and Shelves, 18mm Sides and Back, Locking Hinged Doors, Adjustable Feet, 1 fixed and 3 adjustable shelves

- P20** 900mmW x 450mmD x 1800mmH
(Includes 3 Adjustable and 1 Fixed Shelf)

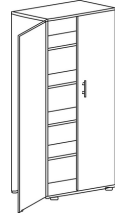

CODE	CARTON DIMENSIONS	CRTN QTY	WEIGHT / VOL
P20	980mm x 490mm x 152mm	3	99.5KG (0.23CBM)
	1787mm x 485mm x 75mm		
	1765mm x 900mm x 19mm		

UTILITY CABINET

25mm Top, Base, 18mm Shelves, Sides and Back, Locking Hinged Doors, Adjustable Feet, 2 x Adjustable Shelves

- P37** 900mmW x 600mmD x 900mmH
(Includes 2 Adjustable Shelves)

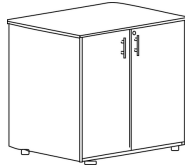

CODE	CARTON DIMENSIONS	CRTN QTY	WEIGHT / VOL
P37	1060mm x 640mm x 88mm	2	63KG (0.16CBM)
	1196mm x 886mm x 56mm		

CREDENZA

25mm Top, Base, 18mm Shelves, Sides and Back, Sliding Lockable Doors, Adjustable Feet, 1 x Adjustable Shelf either side of centre division

- P23** 1200mmW x 450mmD x 720mmH
P24 1500mmW x 450mmD x 720mmH
P25 1800mmW x 450mmD x 720mmH

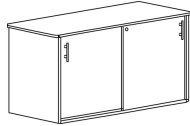

CODE	CARTON DIMENSIONS	CRTN QTY	WEIGHT / VOL
P23	1240mm x 694mm x 61mm	2	48KG (0.14CBM)
	685mm x 634mm x 129mm		
P24	1540mm x 694mm x 61mm	2	63KG (0.16CBM)
	837mm x 760mm x 93mm		
P25	1840mm x 694mm x 61mm	2	73KG (0.19CBM)
	934mm x 685mm x 111mm		

HUTCH

25mm Top, Shelves, 18mm Sides and Back
2 x Adjustable Shelves 290mmD
From desktop to underside of shelf is 450mm

- P27** 1200mmW x 313mmD x 1205mmH
P28 1500mmW x 313mmD x 1205mmH
P29 1800mmW x 313mmD x 1205mmH

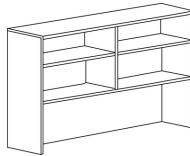

CODE	CARTON DIMENSIONS	CRTN QTY	WEIGHT / VOL
P27	1240mm x 376mm x 132mm	2	51.5KG (0.13CBM)
	1223mm x 1195mm x 19mm		
P28	1540mm x 376mm x 132mm	2	60KG (0.16CBM)
	1495mm x 1223mm x 19mm		
P29	1840mm x 376mm x 132mm	2	68KG (0.19CBM)
	1795mm x 1223mm x 19mm		

HUTCH DOOR KIT

Hutch Doors include Handles and Clip on-Clip off Hinges, and are Non-Locking

- P82** To Suit P27, 1200mmW Hutch
P83 To Suit P28, 1500mmW Hutch
P84 To Suit P29, 1800mmW Hutch

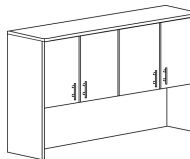

CODE	CARTON DIMENSIONS	CRTN QTY	WEIGHT / VOL
P82	767mm x 357mm x 74mm	1	13KG (0.02CBM)
P83	767mm x 432mm x 74mm	1	14KG (0.03CBM)
P84	790mm x 485mm x 74mm	1	17KG (0.04CBM)

RECEPTION HOB

25mm Top, 18mm Shelf, Sides and Back, 1 Adjustable Shelf for either the left or right opening

- P31** 1800mmW x 300mmD x 425mmH

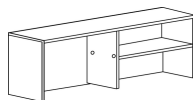

CODE	CARTON DIMENSIONS	CRTN QTY	WEIGHT / VOL
P31	1840mm x 440mm x 70mm	1	28KG (0.07CBM)



STELLA

WHITE MELAMINE RANGE WHITE ALL OVER

DESK

With cable access and adjustable feet
25 mm over 18 mm

- SW1** 1800mmW x 900mmD x 720mmH
- SW36** 1800mmW x 750mmD x 720mmH
- SW2** 1500mmW x 750mmD x 720mmH
- SW3** 1200mmW x 750mmD x 720mmH
- SW4** 1200mmW x 600mmD x 720mmH
No cable access for SW4

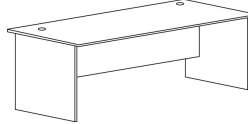

CODE	CARTON DIMENSIONS	CRTN QTY	WEIGHT / VOL
SW1	1840mm x 940mm x 26mm	2	56KG (0.15CBM)
	1770mm x 728mm x 45mm		
SW36	1840mm x 790mm x 27mm	2	48KG (0.14CBM)
	1742mm x 728mm x 45mm		
SW2	1540mm x 790mm x 70mm	1	42KG (0.1CBM)
SW3	1416mm x 790mm x 70mm	1	37KG (0.09CBM)
SW4	1416mm x 640mm x 70mm	1	30KG (0.08CBM)

RETURN

Left or Right hand, Reversible
25 mm over 18 mm

- SW5** 1200mmW x 600mmD x 720mmH
- SW6** 900mmW x 600mmD x 720mmH
- SW80** 600mmW x 600mmD x 720mmH

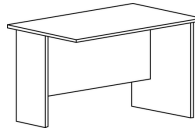

CODE	CARTON DIMENSIONS	CRTN QTY	WEIGHT / VOL
SW5	1240mm x 728mm x 70mm	1	28KG (0.07CBM)
SW6	940mm x 728mm x 70mm	1	23KG (0.05CBM)
SW80	640mm x 728mm x 95mm	1	18KG (0.04CBM)

BRIDGING LEG

Use to extend L-Shape or Corner Workstations
18mmT

- SW38** 260mmW x 695mmH x 18mmT



CODE	CARTON DIMENSIONS	CRTN QTY	WEIGHT / VOL
SW38	750mm x 300mm x 26mm	1	4KG (0.01CBM)

L - SHAPE DESK

Available Left or Right hand - With Cable Access
25 mm over 18 mm

- SW11** 1500mmL x 1200mmW x 600mmD x 720mmH

- 11L** = 1200mmL on the LEFT as you sit at the desk
- 11R** = 1200mmL on the RIGHT as you sit at the desk

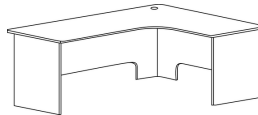

CODE	CARTON DIMENSIONS	CRTN QTY	WEIGHT / VOL
SW11L	1540mm x 1240mm x 26mm	2	57KG (0.13CBM)
	1415mm x 728mm x 63mm		
SW11R	1540mm x 1240mm x 26mm	2	57KG (0.13CBM)
	1415mm x 728mm x 63mm		

May be extended either left or right by adding return code: 5, 6 or 80 plus bridging leg code : 38

CORNER UNIT

With cable access and adjustable feet
25 mm over 18 mm

- SW12** 900mmW x 900mmD x 720mmH
- Add returns:
- SW5 - 1200mmW x 600mmD
- SW6 - 900mmW x 600mmD
- SW80 - 600mmW x 600mmD

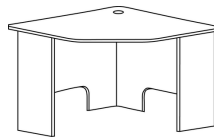

CODE	CARTON DIMENSIONS	CRTN QTY	WEIGHT / VOL
SW12	988mm x 940mm x 77mm	1	34KG (0.08CBM)

MOBILE PEDESTAL

2 Drawers + 1 File Drawer - with Lock and Pencil Tray

- SW14** 415mmW x 500mmD x 675mmH



CODE	CARTON DIMENSIONS	CRTN QTY	WEIGHT / VOL
SW14	420mm x 505mm x 663mm	1	27KG (0.15CBM)

Factory assembled - castors and handles to be fitted

FIXED PEDESTAL

With Lock and Pencil Tray

- SW8** 410mmW x 500mmD x 450mmH
(3 Drawers)
- SW9** 410mmW x 500mmD x 450mmH
(1 File Drawer + 1 Drawer)

*Fixed pedestals are discontinued and only available while stocks last

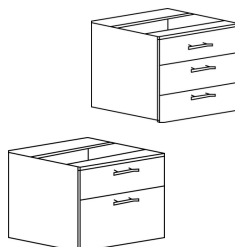

CODE	CARTON DIMENSIONS	CRTN QTY	WEIGHT / VOL
SW8*	420mm x 505mm x 490mm	1	20KG (0.12CBM)
SW9*	420mm x 505mm x 490mm	1	18KG (0.12CBM)

*Discontinued - available while stocks last
Factory assembled - handles to be fitted



STELLA

WHITE MELAMINE RANGE WHITE ALL OVER

BOOKCASE

25mm Top, Base and Shelves, 18mm Sides and Back
308mm D Shelves

- SW19** 900mmW x 330mmD x 1800mmH
(1 Fixed, 3 Adjustable Shelves) *image displayed
SW42 900mmW x 330mmD x 900mmH
(2 Adjustable Shelves) *image not displayed

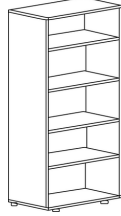

CODE	CARTON DIMENSIONS	CRTN QTY	WEIGHT / VOL
SW19	940mm x 374mm x 153mm	2	66KG (0.15CBM)
	1765mm x 898mm x 37mm		
SW42	898mm x 868mm x 38mm	2	38KG (0.09CBM)
	960mm x 374mm x 102mm		

STATIONERY CABINET

25mm Top, Base and Shelves, 18mm Sides and Back, Hinged Locking
Doors, Adjustable Feet, 1 fixed and 3 adjustable shelves

- SW20** 900mmW x 450mmD x 1800mmH
(Includes 3 Adjustable and 1 Fixed Shelf)



CODE	CARTON DIMENSIONS	CRTN QTY	WEIGHT / VOL
SW20	980mm x 490mm x 152mm	3	99.5KG (0.23CBM)
	1787mm x 485mm x 75mm		
	1765mm x 900mm x 19mm		

CREDENZA

25mm Top, Base, 18mm Shelves, Sides and Back, Sliding Lockable Doors,
Adjustable Feet, 1 x Adjustable Shelf either side of centre division

- SW23** 1200mmW x 450mmD x 720mmH
SW24 1500mmW x 450mmD x 720mmH
SW25 1800mmW x 450mmD x 720mmH

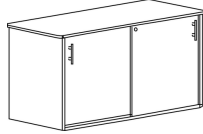

CODE	CARTON DIMENSIONS	CRTN QTY	WEIGHT / VOL
SW23	1240mm x 694mm x 61mm	2	48KG (0.14CBM)
	685mm x 634mm x 129mm		
SW24	1540mm x 694mm x 61mm	2	63KG (0.16CBM)
	837mm x 760mm x 93mm		
SW25	1840mm x 694mm x 61mm	2	73KG (0.19CBM)
	934mm x 685mm x 111mm		

HUTCH

25mm Top, Shelves, 18mm Sides and Back
2 x Adjustable Shelves 290mmD
From desktop to underside of shelf is 450mm

- SW27** 1200mmW x 313mmD x 1205mmH
SW28 1500mmW x 313mmD x 1205mmH
SW29 1800mmW x 313mmD x 1205mmH

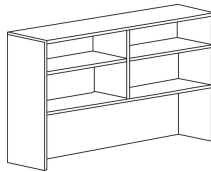

CODE	CARTON DIMENSIONS	CRTN QTY	WEIGHT / VOL
SW27	1240mm x 376mm x 132mm	2	51.5KG (0.13CBM)
	1223mm x 1195mm x 19mm		
SW28	1540mm x 376mm x 132mm	2	60KG (0.16CBM)
	1495mm x 1223mm x 19mm		
SW29	1840mm x 376mm x 132mm	2	68KG (0.19CBM)
	1795mm x 1223mm x 19mm		

HUTCH DOOR KIT

Hutch Doors include Handles and Clip on-Clip off Hinges, and are Non-
Locking

- SW82** To Suit P27, 1200mmW Hutch
SW83 To Suit P28, 1500mmW Hutch
SW84 To Suit P29, 1800mmW Hutch

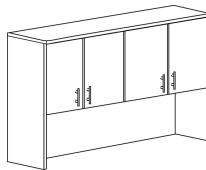

CODE	CARTON DIMENSIONS	CRTN QTY	WEIGHT / VOL
SW82	767mm x 357mm x 74mm	1	13KG (0.02CBM)
SW83	767mm x 432mm x 74mm	1	14KG (0.03CBM)
SW84	790mm x 485mm x 74mm	1	17KG (0.04CBM)

RECEPTION HOB

25mm Top, 18mm Shelf, Sides and Back, 1 Adjustable Shelf for either the
left or right opening

- SW31** 1800mmW x 300mmD x 425mmH

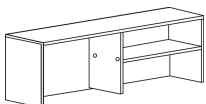

CODE	CARTON DIMENSIONS	CRTN QTY	WEIGHT / VOL
SW31	1840mm x 440mm x 70mm	1	28KG (0.07CBM)



STELLA

MELAMINE TOP RANGE

STRAIGHT TOP

- **Top 1890** - 1800mmL x 900mmD x 25mmT
- **Top 1875** - 1800mmL x 750mmD x 25mmT
- **Top 1575** - 1500mmL x 750mmD x 25mmT
- No cable hole access - cable hole available at additional cost (includes 60mm cover)
- 25mm E1 particle board
- **Colour: White**

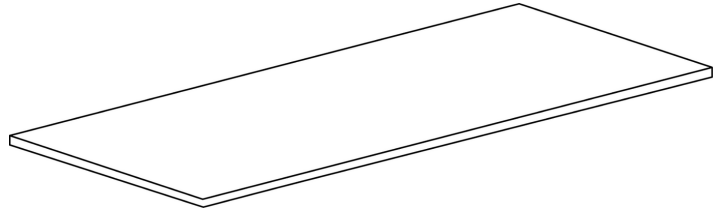

CODE	CARTON DIMENSIONS	CRTN QTY	WEIGHT / VOL
TOP1890	1840mm x 940mm x 30mm	1	26KG (0.07CBM)
TOP1875	1840mm x 790mm x 30mm	1	25KG (0.06CBM)
TOP1575	1540mm x 790mm x 30mm	1	21KG (0.05CBM)

STRAIGHT TOPS WITH SCALLOP

- **T1** - 1800mmL x 750mmD x 25mmT
- **T2** - 1500mmL x 750mmD x 25mmT
- 600mm x 45mm scallop on back edge
- 25mm E1 particle board
- **Colour: White**

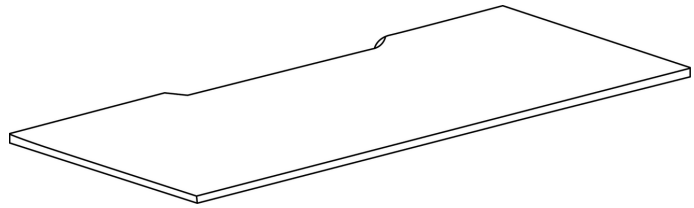

CODE	CARTON DIMENSIONS	CRTN QTY	WEIGHT / VOL
T1	1840mm x 790mm x 30mm	1	25KG (0.06CBM)
T2	1540mm x 790mm x 30mm	1	21KG (0.05CBM)

CORNER TOP

- **T3** - 1800mmL x 1800mmW x 750mmD x 25mmT
- **T4** - 1800mmL x 1500mmW x 750mmD x 25mmT
- **T5** - 1800mmL x 1200mmW x 750mmD x 25mmT
- Cable hole access
- 25mm E1 particle board
- **Colour: White**

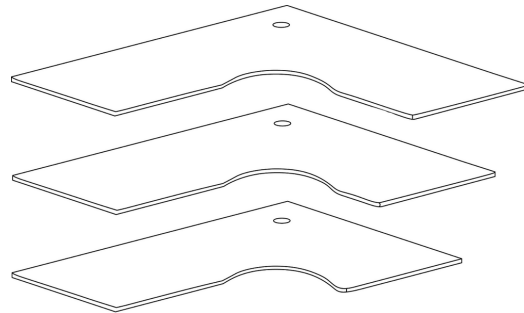

CODE	CARTON DIMENSIONS	CRTN QTY	WEIGHT / VOL
T3	1840mm x 1840mm x 790mm x 30mm	1	38KG (0.07CBM)
T4	1840mm x 1540mm x 790mm x 30mm	1	36KG (0.06CBM)
T5	1840mm x 1240mm x 790mm x 30mm	1	34KG (0.05CBM)

ROUND TOP

- **TOP 1050** - 1050 Dia x 25mmT
- 25mm E1 particle board
- **Colour: White, Beech**

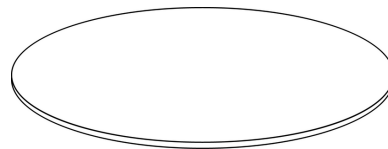

CODE	CARTON DIMENSIONS	CRTN QTY	WEIGHT / VOL
Top1050W	1080mm x 30mm Dia	1	15KG (0.06CBM)

* Beech colour discontinued - available while stocks last

MODESTY PANEL

- Melamine 18mm panel with polished aluminum brackets
- Brackets are included with panel
- 2 sizes available:
1500mmL x 450mmH
1200mmL x 450mmH
- Including the bracket, the modesty hangs 510mm from the bottom of the desk top
- **Colour: White**

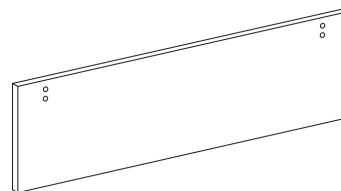

CODE	DIMENSIONS	CRTN QTY	WEIGHT / VOL
DM1	1500 mm x 450 mm x 18 mm	1	8.5KG (0.012CBM)
M2	1200 mm x 450 mm x 18 mm	1	6KG (0.01CBM)
ModBR	130mm x 40mm x 25mm	1	200G (0.05CBM)

KIS 2 STEEL PEDESTALS AND ACCESSORIES

STANDARD MOBILE PEDESTAL

- **MR390** - 390mmW x 520mmD x 600mmH
- Stationery Tray in Top Drawer
- Locking Mechanism + Key
- Locking Castors
- 5 Year Warranty
- **Colour: Black, White**



CODE	DESCRIPTION	CARTON DIMENSIONS	CRTN QTY	WEIGHT / VOL
MR390*	Standard Mobile Pedestal	440mm x 580mm x 650mm	1	19.8KG (0.165CBM)

* Colour to be selected: B = Black, W = White

SLIMLINE MOBILE PEDESTAL

- **MR300** - 300mmW x 520mmD x 600mmH
- Stationery Tray in Top Drawer
- Locking Mechanism + Key
- Locking Castors
- 5 Year Warranty
- **Colour: Black, White**



CODE	DESCRIPTION	CARTON DIMENSIONS	CRTN QTY	WEIGHT / VOL
MR300*	Slimline Mobile Pedestal	350mm x 580mm x 650mm	1	17.25KG (0.132CBM)

* Colour to be selected: B = Black, W = White

VERTILIFT UTILITY DRAWER

- **VERTD** - 480mmW x 260mmD x 50mmH
- Mounts to Underside of Top
- Non - Locking
- Metal-Bearing Runners
- 3 Year Warranty
- **Colour: Black, White, Silver**



CODE	DESCRIPTION	CARTON DIMENSIONS	CRTN QTY	WEIGHT / VOL
VERTD*	Vertilift Utility Drawer	505mm x 275mm x 65mm	1	3KG (0.009CBM)

* Colour to be selected: B = Black, W = White, S = Silver

METAL PEDESTAL BASE

- **TB60B** - 600mm Dia Base x 690mmH
- Weighted Base to prevent tipping
- Base includes Adjustable Feet
- Suits Top Sizes - 900mm dia, 1050mm dia, 1200mm dia
- 5 Year Warranty
- **Colour: Black**



*PEDESTAL BASE AND TOP SOLD SEPARATELY

CODE	DESCRIPTION	CARTON DIMENSIONS	CRTN QTY	WEIGHT / VOL
TB60B	Metal Pedestal Base	625mm x 625mm x 55mm	2	29KG (0.02CBM)
		100mm x 100mm x 700mm		

ASPIRE MEDIUM BACK FABRIC

- Upholstered in black fabric
- Weight activated mechanism
- Ratchet adjustable back height
- Adjustable seat height
- Adjustable back and seat angle
- Adjustable seat depth, seat slide
- Moulded comfort foam
- Non marking castors
- Black nylon base
- 7 Year warranty
- AFRDI weight rated **135kg**
- AFRDI Level 6



RATED LOAD

Blue Tick
Product
Certification



CODE	CARTON DIMENSIONS	CRTN QTY	WEIGHT / VOL
AspireMB	670 mm x 650 mm x 310 mm	1	21KG (0.14CBM)
SLarms	360 mm x 360 mm x 170 mm	1	4.5KG (0.089CBM)

ASPIRE HIGH BACK FABRIC

- Upholstered in black fabric
- Weight activated mechanism
- Ratchet adjustable back height
- Adjustable seat height
- Adjustable back and seat angle
- Adjustable seat depth, seat slide
- Moulded comfort foam
- Adjustable lumbar support
- Non marking castors
- Black nylon base
- 7 Year warranty
- AFRDI weight rated **135kg**
- AFRDI Level 6



RATED LOAD

Blue Tick
Product
Certification



CODE	CARTON DIMENSIONS	CRTN QTY	WEIGHT / VOL
AspireHB	670 mm x 650 mm x 310 mm	1	21KG (0.17CBM)
SLarms	360 mm x 360 mm x 170 mm	1	4.5KG (0.089CBM)

ASPIRE HIGH BACK MESH

- Seat upholstered seat in black fabric
- Black mesh high back
- Weight activated mechanism
- Ratchet adjustable back height
- Adjustable seat height
- Adjustable back and seat angle
- Adjustable seat depth, seat slide
- Moulded comfort foam
- Adjustable lumbar support
- Non marking castors
- Black nylon base
- 7 Year warranty
- AFRDI weight rated **135kg**
- AFRDI level 6



RATED LOAD

Blue Tick
Product
Certification



CODE	CARTON DIMENSIONS	CRTN QTY	WEIGHT / VOL
AspireHBM	670 mm x 650 mm x 310 mm	1	23KG (0.17CBM)
SLarms	360 mm x 360 mm x 170 mm	1	4.5KG (0.089CBM)

ASPIRE HIGH BACK WITH HEADREST

- Seat upholstered in black fabric
- Black **mesh or fabric** high back
- Black **mesh or fabric** adjustable headrest
- Weight activated mechanism
- Ratchet adjustable back height
- Adjustable seat height
- Adjustable back and seat angle
- Adjustable seat depth, seat slide
- Moulded comfort foam
- Adjustable lumbar support
- Non marking castors
- Black nylon base
- 7 Year warranty
- AFRDI weight rated **135kg**
- AFRDI level 6



RATED LOAD

Blue Tick
Product
Certification



CODE	CARTON DIMENSIONS	CRTN QTY	WEIGHT / VOL
AspireHB	670 mm x 650 mm x 310 mm	1	21KG (0.17CBM)
AspireHBM	670 mm x 650 mm x 310 mm	1	21KG (0.17CBM)
SLarms	360 mm x 360 mm x 170 mm	1	4.5KG (0.089CBM)
HRMesh / HRFabric	360 mm x 360 mm x 170 mm	1	1KG (0.089CBM)

ENDEAVOUR 103

- Upholstered in black fabric
- Pronounced lumbar support
- Adjustable back & seat height
- Adjustable back and seat angle
- Adjustable seat depth, seat slide
- Moulded comfort foam
- Non marking castors
- Black nylon base
- 7 Year warranty
- AFRDI weight rated **160kg**
- AFRDI level 6



RATED LOAD
Blue Tick
Product
Certification



CODE	CARTON DIMENSIONS	CRTN QTY	WEIGHT / VOL
End	680 mm x 650 mm x 330 mm	1	21KG (0.15CBM)
SLarms	360 mm x 360 mm x 170 mm	1	4.5KG (0.089CBM)

ENDEAVOUR 103 PU

- Upholstered in black antimicrobial PU
- Pronounced lumbar support
- Adjustable back & seat height
- Adjustable back and seat angle
- Adjustable seat depth, seat slide
- Moulded comfort foam
- Non marking castors
- Black nylon base
- 7 Year warranty
- AFRDI weight rated **160kg**
- AFRDI level 6



RATED LOAD
Blue Tick
Product
Certification



CODE	CARTON DIMENSIONS	CRTN QTY	WEIGHT / VOL
EndPU	680 mm x 650 mm x 330 mm	1	21KG (0.15CBM)
SLarms	360 mm x 360 mm x 170 mm	1	4.5KG (0.089CBM)

ENDEAVOUR 103 DRAFTING

- Upholstered in black fabric or PU
- Pronounced lumbar support
- Drafting Stem & Foot rest
- Adjustable back & seat height
- Adjustable back and seat angle
- Adjustable seat depth, seat slide
- Moulded comfort foam
- Non marking castors
- Black nylon base
- 7 Year warranty



CODE	CARTON DIMENSIONS	CRTN QTY	WEIGHT / VOL
End	680 mm x 650 mm x 330 mm	1	21KG (0.15CBM)
EndPU	680 mm x 650 mm x 330 mm	1	21KG (0.15CBM)
SLarms	360 mm x 360 mm x 170 mm	1	4.5KG (0.089CBM)
SLDKit	580 mm x 490 mm x 90 mm	1	4KG (0.026CBM)

ERGOFORM

- Upholstered in Black fabric
- Adjustable seat height
- Adjustable ratchet back height
- Adjustable back and seat angle
- Adjustable seat depth, seat slide
- Moulded comfort foam
- Non-marking castors
- Black nylon base
- 7 Year warranty
- AFRDI level 6
- AFRDI weight rated **160kg**



RATED LOAD

Blue Tick
Product
Certification



CODE	CARTON DIMENSIONS	CRTN QTY	WEIGHT / VOL
Ergo	680 mm x 640 mm x 370 mm	1	23KG (0.17CBM)
SLarms	360 mm x 360 mm x 170 mm	1	4.5KG (0.089CBM)

ERGOFORM PU

- Upholstered in Antimicrobial PU
- Adjustable seat height
- Adjustable ratchet back height
- Adjustable back and seat angle
- Adjustable seat depth, seat slide
- Moulded comfort foam
- Non-marking castors
- Black nylon base
- 7 Year warranty
- AFRDI level 6
- AFRDI weight rated **160kg**



RATED LOAD

Blue Tick
Product
Certification



CODE	CARTON DIMENSIONS	CRTN QTY	WEIGHT / VOL
ErgoPU	680 mm x 640 mm x 370 mm	1	23KG (0.17CBM)
SLarms	360 mm x 360 mm x 170 mm	1	4.5KG (0.089CBM)

ERGO AIR

- Upholstered in Black fabric
- Pneumatic lumbar air pump
- Adjustable seat height
- Adjustable ratchet back height
- Adjustable back and seat angle
- Adjustable seat depth, seat slide
- Moulded comfort foam
- Non-marking castors
- Black nylon base
- 7 Year warranty
- AFRDI level 6
- AFRDI weight rated **160kg**



RATED LOAD

Blue Tick
Product
Certification



CODE	CARTON DIMENSIONS	CRTN QTY	WEIGHT / VOL
ErgoAir	700 mm x 640 mm x 370 mm	1	23KG (0.16CBM)
SLarms	360 mm x 360 mm x 170 mm	1	4.5KG (0.089CBM)

ERGOFORM DRAFTING

- Drafting stem and foot ring
- Upholstered in Black fabric or PU
- Pneumatic lumbar air pump only available with Black fabric
- Adjustable seat height
- Adjustable ratchet back height
- Adjustable back and seat angle
- Adjustable seat depth, seat slide
- Moulded comfort foam
- Non-marking castors
- Black nylon base
- 7 Year warranty



CODE	CARTON DIMENSIONS	CRTN QTY	WEIGHT / VOL
Ergo	680 mm x 640 mm x 370 mm	1	23KG (0.17CBM)
ErgoPU	680 mm x 640 mm x 370 mm	1	23KG (0.17CBM)
ErgoAir	700 mm x 640 mm x 370 mm	1	23KG (0.17CBM)
SLarms	360 mm x 360 mm x 170 mm	1	4.5KG (0.089CBM)
SLDKit	580 mm x 490 mm x 90 mm	1	4KG (0.026CBM)

KIMBERLY MEDIUM BACK

- Seat upholstered in black fabric
- Black mesh back
- Adjustable seat height
- Adjustable ratchet back height
- Adjustable back and seat angle (1 lever)
- Moulded comfort foam
- Non marking castors
- Black nylon base
- BIFMA approved
- 5 Year warranty
- Weight rated **110kg**

BIFMA



CODE	CARTON DIMENSIONS	CRTN QTY	WEIGHT / VOL
KimBLK	640 mm x 640 mm x 340 mm	1	23KG (0.17CBM)
SLarms	360 mm x 360 mm x 170 mm	1	4.5KG (0.089CBM)

KIMBERLY HIGH BACK

- Seat Upholstered in black fabric
- Black mesh high back
- Adjustable seat height
- Adjustable back and seat angle (1 lever)
- Moulded comfort foam
- Non marking castors
- Black nylon base
- BIFMA approved
- 5 Year warranty
- Weight rated **110kg**

BIFMA



CODE	CARTON DIMENSIONS	CRTN QTY	WEIGHT / VOL
KimHBB	690 mm x 620 mm x 330 mm	1	23KG (0.17CBM)
SLarms	360 mm x 360 mm x 170 mm	1	4.5KG (0.089CBM)

MADRID MEDIUM BACK

- Upholstered seat in black fabric
- Black mesh back
- Ratchet adjustable back height
- Adjustable seat height
- Adjustable back and seat angle
- Adjustable seat depth, seat slide
- Moulded comfort foam
- Non marking castors
- Black nylon base
- 7 Year warranty
- AFRDI weight rated **110kg**
- AFRDI level 6



CODE	CARTON DIMENSIONS	CRTN QTY	WEIGHT / VOL
Madrid	670 mm x 650 mm x 310 mm	1	21KG (0.14CBM)
SLarms	360 mm x 360 mm x 170 mm	1	4.5KG (0.089CBM)

MADRID MEDIUM BACK POLISHED BASE

- Upholstered seat in black fabric
- Black mesh back
- Polished alloy base
- Ratchet adjustable back height
- Adjustable seat height
- Adjustable back and seat angle
- Adjustable seat depth, seat slide
- Moulded comfort foam
- Non marking castors
- 7 Year warranty
- Weight rated **110kg**



CODE	CARTON DIMENSIONS	CRTN QTY	WEIGHT / VOL
MadridP	670 mm x 650 mm x 310 mm	1	21KG (0.14CBM)
SLarms	360 mm x 360 mm x 170 mm	1	4.5KG (0.089CBM)

MADRID MEDIUM BACK DRAFTING

- Upholstered seat in black fabric
- Black mesh back
- Drafting Stem & Foot ring
- Ratchet adjustable back height
- Adjustable seat height
- Adjustable back and seat angle
- Adjustable seat depth, seat slide
- Moulded comfort foam
- Non marking castors
- Black nylon base
- 7 Year warranty



CODE	CARTON DIMENSIONS	CRTN QTY	WEIGHT / VOL
Madrid	670 mm x 650 mm x 310 mm	1	21KG (0.14CBM)
SLarms	360 mm x 360 mm x 170 mm	1	4.5KG (0.089CBM)
SLDKit	580 mm x 490 mm x 90 mm	1	4KG (0.026CBM)

MADRID HIGH BACK

- Upholstered seat in black fabric
- Black high mesh back
- Ratchet adjustable back height
- Adjustable seat height
- Adjustable back and seat angle
- Adjustable seat depth, seat slide
- Moulded comfort foam
- Adjustable lumbar support
- Non marking castors
- Black nylon base
- 7 Year warranty
- AFRDI weight rated **110kg**
- AFRDI level 6



CODE	CARTON DIMENSIONS	CRTN QTY	WEIGHT / VOL
MadridHBB	720 mm x 650 mm x 310 mm	1	22KG (0.15CBM)
SLarms	360 mm x 360 mm x 170 mm	1	4.5KG (0.089CBM)

MADRID HIGH BACK POLISHED BASE

- Upholstered seat in black fabric
- Black mesh high back
- Polished Alloy Base
- Ratchet adjustable back height
- Moulded comfort foam
- Adjustable lumbar support
- Adjustable back and seat angle
- Adjustable seat depth, seat slide
- Adjustable seat height
- Non marking castors
- 7 Year warranty
- Weight rated **110kg**



CODE	CARTON DIMENSIONS	CRTN QTY	WEIGHT / VOL
MadridHBP	720 mm x 650 mm x 310 mm	1	22KG (0.15CBM)
SLarms	360 mm x 360 mm x 170 mm	1	4.5KG (0.089CBM)

MADRID HIGH BACK WITH HEADREST

- Upholstered seat in black fabric
- Black mesh high back
- Black mesh adjustable headrest
- Ratchet adjustable back height
- Adjustable seat height
- Adjustable back and seat angle
- Adjustable seat depth, seat slide
- Moulded comfort foam
- Adjustable lumbar support
- Non marking castors
- Black nylon base
- 7 Year warranty
- AFRDI weight rated **110kg**
- AFRDI level 6



CODE	CARTON DIMENSIONS	CRTN QTY	WEIGHT / VOL
MadridHBB	720 mm x 650 mm x 310 mm	1	22KG (0.15CBM)
SLarms	360 mm x 360 mm x 170 mm	1	4.5KG (0.089CBM)
HRMesh	360 mm x 360 mm x 170 mm	1	1KG (0.089CBM)

MERIDA MEDIUM BACK

- Upholstered seat in black fabric
- Black mesh back
- Adjustable seat height
- Adjustable ratchet back height
- Adjustable back and seat angle
- Adjustable seat depth, seat slide
- Moulded comfort foam
- Non marking castors
- Black nylon base
- 7 Year warranty
- AFRDI weight rated **160kg**
- AFRDI Level 6



RATED LOAD

Blue Tick
Product
Certification



CODE	CARTON DIMENSIONS	CRTN QTY	WEIGHT / VOL
MeridaMB	690 mm x 640 mm x 350 mm	1	25KG (0.15CBM)
SLarms	360 mm x 360 mm x 170 mm	1	4.5KG (0.089CBM)

MERIDA HIGH BACK

- Upholstered seat in black fabric
- Black mesh high back
- Adjustable seat height
- Adjustable ratchet back height
- Adjustable back and seat angle
- Adjustable seat depth, seat slide
- Moulded comfort foam
- Non marking castors
- Black nylon base
- 7 Year warranty
- AFRDI weight rated **160kg**
- AFRDI Level 6



RATED LOAD

Blue Tick
Product
Certification



CODE	CARTON DIMENSIONS	CRTN QTY	WEIGHT / VOL
MeridaHBB	670 mm x 650 mm x 370 mm	1	23KG (0.092CBM)
SLarms	360 mm x 360 mm x 170 mm	1	4.5KG (0.089CBM)

MIRAE MEDIUM BACK

- Upholstered seat in black fabric
- Black mesh back
- Adjustable seat height
- Adjustable ratchet back height
- Adjustable back and seat angle
- Adjustable seat depth, seat slide
- Moulded comfort foam
- Non marking castors
- Black nylon base
- 7 Year warranty
- AFRDI weight rated **160kg**
- AFRDI Level 6



RATED LOAD
Blue Tick
Product
Certification



CODE	CARTON DIMENSIONS	CRTN QTY	WEIGHT / VOL
Mirae	670 mm x 640 mm x 370 mm	1	23KG (0.17CBM)
SLarms	360 mm x 360 mm x 170 mm	1	4.5KG (0.089CBM)

MIRAE MEDIUM BACK PU

- Upholstered seat in black antimicrobial PU
- Black mesh back
- Adjustable seat height
- Adjustable ratchet back height
- Adjustable back and seat angle
- Adjustable seat depth, seat slide
- Moulded comfort foam
- Non marking castors
- Black nylon base
- 7 Year warranty
- AFRDI weight rated **160kg**
- AFRDI Level 6



RATED LOAD
Blue Tick
Product
Certification



CODE	CARTON DIMENSIONS	CRTN QTY	WEIGHT / VOL
MiraePU	670 mm x 640 mm x 370 mm	1	23KG (0.17CBM)
SLarms	360 mm x 360 mm x 170 mm	1	4.5KG (0.089CBM)

MIRAE MEDIUM BACK POLISHED BASE

- Seat upholstered in black fabric
- Black mesh back
- Polished alloy base
- Adjustable seat height
- Adjustable ratchet back height
- Adjustable back and seat angle
- Adjustable seat depth, seat slide
- Moulded comfort foam
- Non marking castors
- 7 Year warranty
- Weight rated **110kg**



CODE	CARTON DIMENSIONS	CRTN QTY	WEIGHT / VOL
MiraeP	670 mm x 640 mm x 370 mm	1	23KG (0.17CBM)
SLarms	360 mm x 360 mm x 170 mm	1	4.5KG (0.089CBM)

MIRAE MEDIUM BACK DRAFTING

- Upholstered seat in black fabric or PU
- Black mesh back
- Adjustable seat height
- Adjustable ratchet back height
- Adjustable back and seat angle
- Adjustable seat depth, seat slide
- Drafting stem and foot ring
- Moulded comfort foam
- Non marking castors
- Black nylon base
- 7 Year warranty



CODE	CARTON DIMENSIONS	CRTN QTY	WEIGHT / VOL
Mirae	670 mm x 640 mm x 370 mm	1	23KG (0.17CBM)
MiraePU	670 mm x 640 mm x 370 mm	1	23KG (0.17CBM)
SLarms	360 mm x 360 mm x 170 mm	1	4.5KG (0.089CBM)
SLDkit	580 mm x 490 mm x 90 mm	1	4KG (0.026CBM)

MIRAE HIGH BACK

- Upholstered seat in black fabric
- Black mesh high back
- Adjustable seat height
- Adjustable back and seat angle
- Adjustable seat depth, seat slide
- Moulded comfort foam
- Non marking castors
- Black nylon base
- 7 Year warranty
- AFRDI weight rated **110kg**
- AFRDI level 6



CODE	CARTON DIMENSIONS	CRTN QTY	WEIGHT / VOL
MiraeHBB	690 mm x 640 mm x 390 mm	1	23KG (0.17CBM)
SLarms	360 mm x 360 mm x 170 mm	1	4.5KG (0.089CBM)

MIRAE HIGH BACK POLISHED BASE

- Upholstered seat in black fabric
- Black mesh back
- Polished alloy base
- Adjustable seat height
- Adjustable back and seat angle
- Adjustable seat depth, seat slide
- Moulded comfort foam
- Non marking castors
- 7 Year warranty
- Weight rated **110kg**



CODE	CARTON DIMENSIONS	CRTN QTY	WEIGHT / VOL
MiraeHBP	690 mm x 640 mm x 390 mm	1	23KG (0.17CBM)
SLarms	360 mm x 360 mm x 170 mm	1	4.5KG (0.089CBM)

MIRAE HIGH BACK WITH HEADREST

- Upholstered seat in black fabric
- Black mesh back
- Black mesh adjustable headrest
- Adjustable seat height
- Adjustable back and seat angle
- Adjustable seat depth, seat slide
- Moulded comfort foam
- Non marking castors
- Black nylon base
- 7 Year warranty
- AFRDI weight rated **110kg**
- AFRDI level 6



CODE	CARTON DIMENSIONS	CRTN QTY	WEIGHT / VOL
MiraeHBB	670 mm x 630 mm x 340 mm	1	25KG (0.17CBM)
SLarms	360 mm x 360 mm x 170 mm	1	4.5KG (0.089CBM)
HRMesh	360 mm x 360 mm x 170 mm	1	1KG (0.089CBM)

SEVILLE HIGH BACK

- Upholstered seat in black fabric
- Black mesh high back
- Ratchet adjustable back height
- Adjustable seat height
- Adjustable back and seat angle
- Adjustable seat depth, seat slide
- Moulded comfort foam + lumbar support
- Non marking castors
- Black nylon base
- 7 Year warranty
- AFRDI weight rated **160kg**
- AFRDI level 6



RATED LOAD

Blue Tick
Product
Certification



CODE	CARTON DIMENSIONS	CRTN QTY	WEIGHT / VOL
SevHBB	750 mm x 640 mm x 350 mm	1	24KG (0.17CBM)
SLarms	360 mm x 360 mm x 170 mm	1	4.5KG (0.089CBM)

SEVILLE HIGH BACK POLISHED BASE

- Upholstered seat in black fabric
- Black mesh high back
- Polished Alloy Base
- Ratchet adjustable back height
- Moulded comfort foam & Lumbar support
- Adjustable lumbar support
- Adjustable back and seat angle
- Adjustable seat depth, seat slide
- Adjustable seat height
- Non marking castors
- 7 Year warranty
- Weight rated **110kg**



CODE	CARTON DIMENSIONS	CRTN QTY	WEIGHT / VOL
SevHBP	750 mm x 640 mm x 350 mm	1	24KG (0.17CBM)
SLarms	360 mm x 360 mm x 170 mm	1	4.5KG (0.089CBM)

SEVILLE HIGH BACK, POLISHED KIT

- Upholstered seat in black fabric
- Black high mesh back
- Polished Alloy Base & Alloy Arms
- Ratchet adjustable back height
- Adjustable back and seat angle
- Adjustable seat depth, seat slide
- Moulded comfort foam
- Adjustable lumbar support
- Adjustable seat height
- Non marking castors
- 7 Year warranty
- Weight rated **110kg**



CODE	CARTON DIMENSIONS	CRTN QTY	WEIGHT / VOL
SevAH	750 mm x 640 mm x 350 mm	1	24KG (0.17CBM)

SIENA

- Upholstered seat in black fabric
- Black mesh back
- Weight activated mechanism
- Ratchet adjustable back height
- Adjustable seat height
- Adjustable back and seat angle
- Adjustable seat depth, seat slide
- Moulded comfort foam
- Non marking castors
- Black nylon base
- 5 Year warranty
- AFRDI weight rated **135kg**
- AFRDI level 6



RATED LOAD

Blue Tick
Product
Certification



CODE	CARTON DIMENSIONS	CRTN QTY	WEIGHT / VOL
SIENA	690 mm x 640 mm x 390 mm	1	23KG (0.17CBM)
SLarms	360 mm x 360 mm x 170 mm	1	4.5KG (0.089CBM)

TAYLOR DRAFTING

- Upholstered in Black Fabric
- Adjustable Back Height
- Ergonomic 2-Lever mechanism
- Drafting Stem & Foot Rest
- Moulded comfort foam
- Adjustable back and seat angle
- Adjustable seat height
- Non marking castors
- 5 Year warranty



CODE	CARTON DIMENSIONS	CRTN QTY	WEIGHT / VOL
TaylorDKit	610 mm x 600 mm x 350 mm	1	25KG (0.128CBM)

MARICS

- Black frame and base
- Black mesh
- Integrated back, seat & arms
- Weight sensitive mechanism
- Concealed height adjustment
- 5 year warranty
- Weight Rated **110kg**

BIFMA



CODE	CARTON DIMENSIONS	CRTN QTY	WEIGHT / VOL
MARBB	780 mm x 650 mm x 630 mm Carton is a triangle shape	1	19KG (0.32CBM)

STATELINE - SPENCER

- Upholstered seat in black fabric
- Black breathable mesh back
- Powder coated silver sled frame
- Includes linking feet
- Comfort foam
- Stacks 4 high assembled
- Weight rated to **110kg**
- BIFMA approved
- **4 Per Carton**
- 3 Year Warranty

(Price is per chair)

BIFMA



CODE	CARTON DIMENSIONS	CRTN QTY	WEIGHT / VOL
SPENCER	770 mm x 660 mm x 560 mm	1	27KG (0.15CBM)

STATELINE - JORDAN

- Upholstered Seat in black fabric
- Black breathable mesh back
- Stylish drop armrests
- Powder coated black sled frame
- Weight rated to **110kg**
- BIFMA approved
- 5 Year Warranty

BIFMA



CODE	CARTON DIMENSIONS	CRTN QTY	WEIGHT / VOL
JORDAN	810 mm x 590 mm x 230 mm	1	11.5KG (0.11CBM)

M&R - ED VINYL

- Factory assembled
- Upholstered in black vinyl
- Sturdy chrome frame
- Moulded comfort foam
- Stacks 4 high
- Stacks up to 10 on a trolley
- Optional linking feet \$4/Chair
- Weight rated to **110kg**
- 3 Year Warranty



CODE	WEIGHT / VOL
ED-V	5.5KG (0.19CBM)

ARMS

- Adjustable Arm Set to suit:
- Aspire MB & HB
- Endeavour 103 & Endeavour PU
- Ergoform, Ergo Air & Ergoform PU
- Madrid MB & HB
- Merida MB & HB
- Mirae MB & HB, Mirae PU MB
- Seville
- Siena
- **Colour: Black**



CODE	CARTON DIMENSIONS	CRTN QTY	WEIGHT / VOL
SLarms	360 mm x 360 mm x 170 mm	1	4.5KG (0.089CBM)

POLISHED ARMS

- Polished Alloy
- Adjustable Arm Set to suit:
- Endeavour 103
- Mirae MB & HB
- Ergoform and Ergo Air
- Seville
- **Colour: Black/Alloy**



CODE	CARTON DIMENSIONS	CRTN QTY	WEIGHT / VOL
Parms	400 mm x 360 mm x 180 mm	1	5KG (0.026CBM)

MESH HEADREST

- Mesh headrest to suit most HIGH BACK models including:
- Aspire HB
- Madrid HB
- Merida HB
- Mirae HB
- Seville
- **Colour: Black Mesh**



CODE	WEIGHT
HRMesh	0.8KG

FABRIC HEADREST

Fabric Headrest to suit most HIGH BACK models including:

- Aspire HB
- Madrid HB
- Merida HB
- Mirae HB
- Seville
- **Colour: Black Fabric**



CODE	WEIGHT
HRFab	0.8KG

DRAFTING KIT

- Chrome Footring
- Longer Gas cylinder and bellows
- Colour: Alloy Ring and Black Stem

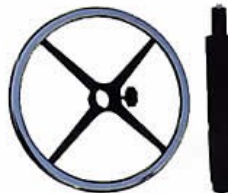

CODE	CARTON DIMENSIONS	CRTN QTY	WEIGHT / VOL
SLDkit	580 mm x 490 mm x 90 mm	1	4KG (0.026CBM)

POLISHED BASE

- Polished Aluminium Base
- Colour: Alloy
- Weight rated to 110kg



CODE	WEIGHT
Pbase	2.5KG

CHAIR GLIDES

- SET OF 5



CODE	WEIGHT / VOL
GLIDES	0.4KG (0.02CBM)

AFRDI



INDIVIDUAL
CERTIFICATES FOR
EACH CHAIR MODEL
AVAILABLE ON
REQUEST

The following chairs are AFRDI Level 6 certified with AFRDI 160kg load rating:

- Endeavour 103
- Endeavour PU
- Ergoform
- Ergo Air
- Ergoform PU
- Mirae Medium Back
- Mirae Medium Back PU
- Seville High Back
- Merida Medium Back
- Merida High Back

The following chairs are AFRDI Level 6 certified with AFRDI 135kg load rating:

- Aspire Medium Back
- Aspire High Back Fabric
- Aspire High Back Mesh
- Siena

The following chairs are AFRDI Level 6 certified:

- Madrid Medium Back
- Madrid High Back
- Mirae High Back

Under the Blue Tick Product Certification these components are certified for:

- Severe Commercial use
- General Safety
- Strength and Durability
- Stability
- Dimensions

The following Stateline components are not AFRDI certified:

- Stateline Arms
- Polished Arms
- Polished Base
- Drafting Kit
- Mesh Headrest
- Fabric Headrest

The following products reduce weight ratings on all chairs back to 110kg:

- Drafting Kit
- Polished Base
- Glides

BIFMA

The following chairs are BIFMA certified:

- Kimberly Medium Back
- Kimberly High Back
- Marics
- Spencer
- Jordan



MELAMINE RANGE SPARE PARTS

PRODUCT
Credenza Push Lock with 2 Keys
Stella Mobile and Fixed Drawer Lock with 2 Keys
Hinged Door Lock with 2 Keys
Master key for Stella Furniture
Pencil Tray for Stella Drawers
Stella Shelf Rest (Pack of 4)
Stella Stainless Steel Handle
Mobile Pedestal Castors
Additional Stella Shelves (includes shelf rests for all codes)
60mm Cable Hole Cover for Beech or White tops
Cut & Fit additional Cable Hole with Cover
Credenza - Top or Bottom Door Glide

KIS2 SPARE PARTS

PRODUCT
Master Key for Steel MR390 & MR300 Mobile Pedestals

Vertilift...

Excellence in motion

VERTILIFT RANGE SPARE PARTS

PRODUCT
Hand Set
Control Box (2 leg , 3 leg)
Power / Link Cables
Replacement Motor
Replacement 3-Stage Electric Leg
700 mmL foot
600 mmL foot
Stick-on Plastic Cable Clip

WARRANTY INFORMATION

Warranty claims for all products should be directed to the distributor from which the product was purchased from. Proof of purchase must be provided with any warranty claim, along with full details of the defect and any further documentation requested e.g. photographs.

Vertilift... Excellence in motion

Vertilift products are sold with a warranty period of 5 years from date of purchase to the original purchaser. This covers the following:

- Failure of electronic components (lifting mechanisms/motors, control boxes and handsets)
- Missing/damaged components at the time of delivery acceptance
- Manufacturing defects including materials and workmanship
- Defects and/or loss in the functionality of the lifting mechanism

The 5-year Vertilift warranty does not cover the following:

- Wear and tear of the Vertilift frame and/or accessories caused by accident, abuse, misuse, water, flood, fire or other acts of nature and external causes.
- Damage incurred during self-assembly due to failure to adhere to relevant assembly instructions provided.
- Damage caused to the Vertilift frame and/or accessories as a result of self-modification or relocation.

This warranty guarantees the replacement of damaged/faulty components only and does not include full replacement of the frame unless determined necessary by M&R Commercial Furniture Pty Ltd.

KIS2 Steel

KIS 2 Steel Pedestals are sold with a warranty period of 5 years from the date of purchase to the original purchaser. This covers the following:

- Missing/damaged components at the time of delivery acceptance
- Manufacturing defects including materials and workmanship
- Defects and/or loss in the functionality

This warranty does not cover the following:

- Wear and tear caused by accident, abuse, misuse, water, flood, fire or other acts of nature and external causes.
- Damage caused as a result of self-modification or relocation.

This warranty guarantees the replacement of damaged/faulty components only and does not include full replacement of the product unless determined necessary by M&R Commercial Furniture Pty Ltd.



Stella products are sold with a warranty period of 3 years from the date of purchase to the original purchaser. This covers the following:

- Missing/damaged components at the time of delivery acceptance
- Manufacturing defects including materials and workmanship
- Defects and/or loss in the functionality

This warranty does not cover the following:

- Wear and tear caused by accident, abuse, misuse, water, flood, fire or other acts of nature and external causes.
- Damage incurred during self-assembly due to failure to adhere to relevant assembly instructions provided.
- Damage caused as a result of self-modification or relocation.

This warranty guarantees the replacement of damaged/faulty components only and does not include full replacement of the product unless determined necessary by M&R Commercial Furniture Pty Ltd.



Stateline extends warranty for a period of 3 - 7 years from date of purchase to the original purchaser. Warranty periods for each Stateline chair are detailed on product pages including AFRDI certifications/ratings. There is a warranty label under the seat which shows the manufacturing date. Warranty is void if this label is removed.

Stateline warranty covers the replacement of faulty or defective components and workmanship only. This includes mechanical or structural breakdown, faulty workmanship and loss of functionality. This warranty guarantees the replacement of damaged/faulty components only and does not include full replacement of chairs unless determined necessary by Stateline.

Modification, misuse, stains or blemishes after accepting delivery of a product will not be covered by warranty. Normal wear and tear or damage determined to be caused by the end-user through misuse shall not be covered. Similarly, fabric on the seat or backrest shall not be covered against wear.



COMMERCIAL FURNITURE PTY LTD

www.mrcommercialfurniture.com.au